

ozito

D.I.Y

Cordless Hammer Drill Kit

18 Volt

Operation Manual

3 Year Replacement Warranty

OZCD18V2A



0109

To view the full range visit: **www.ozito.com.au**

SPECIFICATIONS – MODEL NO. OZCD18V2A

Battery power:	18V
Charge time:	3 - 5 hours
No load speed:	0 – 350 rpm / 0 - 1,100 rpm
Chuck:	10mm, keyless
Batteries:	2
Gearbox:	2 Speed
Hammer function:	Yes
Torque rating:	20Nm
Tool weight + battery:	2.0kg

Features:	Adjustable torque
	19 torque settings
	2-speed gearbox
	Hammer function
	Accessories included

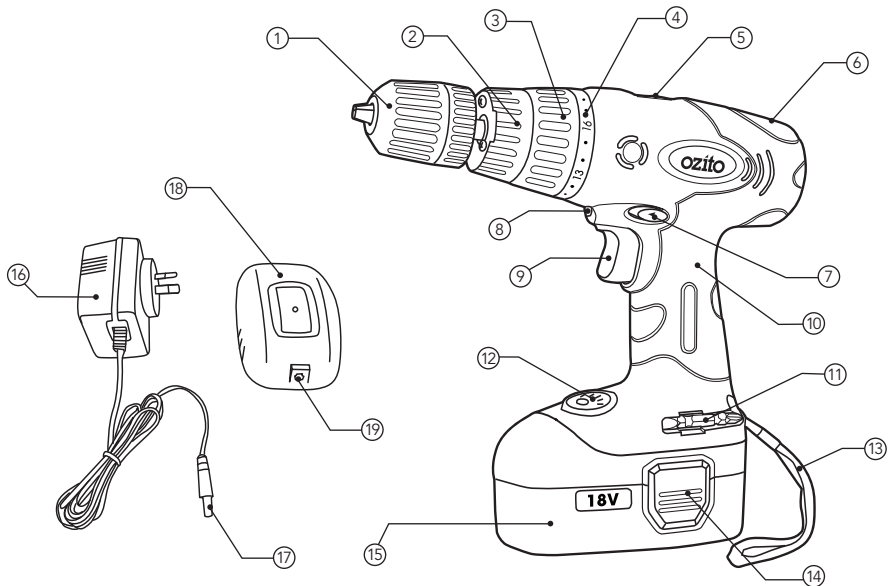

1. Keyless chuck
2. Hammer/Drill selector collar
3. Torque adjustment collar
4. Torque indicator
5. Gearbox speed selector
6. Level indicator
7. Forward/reverse selector
8. Work area LED light
9. Variable speed switch
10. Rubber over-moulding handle

11. Double-ended screwdriver bit
12. Battery power indicator
13. Carry strap
14. Battery pack release button
15. 18V Battery pack
16. 240V AC Charger adaptor
17. Charger jack
18. Charger cradle
19. Charger cradle socket

TABLE OF CONTENTS

SPECIFICATIONS - MODEL NO. OZCD18V2A	Page 1
TABLE OF CONTENTS.....	Page 2
INTRODUCTION.....	Page 3
SAFETY INSTRUCTIONS.....	Page 3
OPERATION	Page 8
MAINTENANCE	Page 10
CONTENTS	Page 10
WARRANTY.....	Page 11

INTRODUCTION

Congratulations on purchasing an Ozito 18V Cordless Hammer Drill. We aim to provide quality tools at an affordable price. We hope you will enjoy using this tool for many years.

Your Ozito Cordless Hammer Drill OZCD18V2A has been designed to drill masonry, metal, plastic and for screw driving. It is intended for DIY use only.

SAFETY INSTRUCTIONS

Warning! A battery operated tool with integral batteries or a separate battery pack must be recharged only with the specific charger for the battery. A charger that may be suitable for one type of battery may create a risk of fire when used with another battery.

- Avoid accidental starting. Make sure the switch is in the locked OFF position before inserting the battery pack. Carrying a tool with your finger on the switch or inserting the battery pack into a tool with the switch on invites accidents.
- Disconnect the battery pack from the tool or place the switch in the locked OFF position before making any adjustments, changing accessories, or storing the tool. Such preventative safety measures reduce the risk of starting the tool accidentally.
- When the battery pack is not in use, keep it away from other metal objects.

Read the whole manual carefully and make sure you know how to switch the tool OFF, in an emergency, before operating the tool. Save these instructions and other documents supplied with this machine for future reference.

GENERAL

1. **Keep work areas clean.** Cluttered areas and benches can cause accidents.
2. **Consider work area environment.** Do not expose your tool to high humidity or rain. Do not use your tool in damp and wet conditions. Keep the work area well lit. Do not use your tool where there is a risk of causing fire or explosion, e.g. in the presence of flammable liquids and gases.
3. **Keep children away.** Do not allow children, visitors or animals to come near the work area or to touch the tool or power lead.
4. **Dress appropriately.** Do not wear loose clothing or jewellery, as these can be caught in moving parts. Preferably wear non-slip footwear when working outdoors. Wear protective hair covering to keep long hair out of the way.

GENERAL (cont.)

5. **Head protection.** Always use safety glasses. Use a face or dust mask whenever the operations may produce dust or flying particles. Wear ear protection whenever the sound level seems uncomfortable.
6. **Guard against electric shock.** Prevent body contact with earthed or grounded surfaces (e.g. pipes, radiators, cookers and refrigerators).
Electric safety can be further improved by using a high sensitivity (30 mA/30 mS) residual current device (RCD).
7. **Do not overreach.** Keep proper footing and balance at all times.
8. **Stay alert.** Watch what you are doing. Use common sense. Do not operate the tool when you are tired.
9. **Secure work piece.** Use clamps or a vice to hold the work piece; it is safer as it frees both hands to operate the tool.
10. **Connect dust extraction equipment.** If devices are provided for the connection of dust extraction and collection facilities, ensure that these are connected and properly used.
11. **Remove adjusting keys and wrenches.** Always check that adjusting keys and wrenches are removed from the tool before operating the tool.
12. **Extension leads.** Before use, inspect the extension leads and replace if damaged. When using the tool outdoors, only use extension leads intended for outdoor use and marked accordingly.
13. **Use appropriate tool.** The intended use is described in this instruction manual. Do not force small tools or attachments to do the job of a heavy duty tool. The tool will do the job better and safer at the rate for which it was intended. Do not force the tool.

Warning! The use of any accessory or attachment, or performance of any operation with this tool other than those recommended in this instruction manual may present a risk of personal injury.

14. **Check for damaged parts.** Before use carefully check the tool and power lead for damage. Check for misalignment and seizure of moving parts, breakage of parts, damage to guards and switches and any other conditions that may affect its operation. Ensure that the tool will operate properly and perform its intended function. Do not use the tool if any parts are damaged or defective. Do not use the tool if the switch does not turn it on and off. Have any damaged or defective parts repaired or replaced by an electrician or power tool repairer. Never attempt any repairs yourself.
15. **Unplug the tool.** Unplug the tool when it is not in use, before changing any parts of the tool, accessories or attachments and before servicing.
16. **Avoid unintentional starting.** Do not carry the tool with a finger on the on/off switch. Make sure the tool is switched off when plugged in.
17. **Do not abuse the cord.** Never carry the tool by its cord or pull it to disconnect from the socket. Keep the cord away from heat, oil and sharp edges.

GENERAL (cont.)

- 18. Store idle tools.** When not in use, tools should be stored in a dry, locked up or high place, out of reach of children.
- 19. Maintain tools with care.** Keep cutting tools sharp and clean for better and safer performance. Follow the instructions for maintenance and changing accessories. Keep handles and switches dry, clean and free from oil and grease.
- 20. Have your tool repaired by an electrician or power tool repairer.** This power tool complies with relevant safety requirements. To avoid danger, electrical appliances must only be repaired by qualified technicians using original spare parts; otherwise this may result in considerable danger to the user.
- 21. Users.** This appliance is not intended for use by young children or infirmed persons without supervision. Young children should be supervised to ensure that they do not play with this appliance.
- 22. Replacement of the supply cord.** If the supply cord is damaged, it must be replaced by an electrician or a power tool repairer in order to avoid a hazard.

CHARGER AND BATTERY PACK SAFETY INSTRUCTIONS

THIS MANUAL CONTAINS IMPORTANT SAFETY AND OPERATING INSTRUCTIONS FOR YOUR BATTERY CHARGER.

- Before using the charger, read all instructions and cautionary markings on charger, battery pack and product using the battery pack.

Danger! If the battery pack case is cracked or damaged, do not insert into charger. There is a danger of electric shock or electrocution.

Warning! Don't allow any liquid to get inside charger. Electric shock may result. To facilitate cooling of the battery pack after use, avoid placing the charger or battery pack in a warm environment such as in a metal shed, or an uninsulated trailer.

- This charger is not intended for any uses other than charging rechargeable batteries. Any other use may result in risk of fire, electric shock or electrocution.
- Do not place any object on top of the charger or place the charger on a soft surface that may result in excessive internal heat. Place the charger in a position away from any heat source.
- To reduce risk of damage to the electric plug and cord, pull by the plug rather than the cord when disconnecting the charger.
- Make sure cord is located so that it will not be stepped on, tripped over, or otherwise subjected to damage or stress.
- An extension cord should not be used unless absolutely necessary. Use of an improper extension cord could result in the risk of fire, electric shock or electrocution.

CHARGER AND BATTERY PACK SAFETY INSTRUCTIONS (cont.)

- Do not operate charger if it has received a sharp blow, been dropped or otherwise damaged in any way. Have it checked by an electrician or power tool repairer.
- Do not disassemble charger. Take it to an electrician or power tool repairer when service or repair is required. Incorrect reassembling may result in a risk of electric shock, electrocution or fire.
- To reduce risk of electric shock, unplug charger from the outlet before attempting any cleaning. Removing the battery pack will not reduce this risk.
- Never attempt to connect 2 chargers together.
- DO NOT store or use the tool and battery pack in locations where the temperature may reach or exceed 40°C (such as outside sheds or metal buildings in summer).
- The charger is designed to operate on standard household electrical power (240 volts). Do not attempt to use it on any other voltage!

ADDITIONAL SAFETY RULES FOR CHARGER AND BATTERY

The battery pack is not fully charged out of the carton. First read the safety instructions and then follow the charging notes and procedures.

- The longest life and best performance can be obtained if the battery pack is charged when the air temperature is between 18 - 24° C. Do not charge the battery pack in an air temperature below 10° C or above 40° C. This is important and will prevent damage to the battery pack.
- Do not incinerate the battery pack even if it is seriously damaged or is completely worn out. The battery can explode in a fire.
- Never attempt to open the battery pack for any reason. If the plastic housing of the battery pack breaks or cracks, immediately discontinue use and do not recharge.

INSTALLING OR REMOVING THE BATTERY PACK

Always switch off the tool before insertion or removal of the battery pack.

To Install the Battery Pack

- Place battery pack on a hard surface like a bench/table. Align slots on the base of the drill handle with the battery. Slide the drill onto the battery ensuring the battery release button locks into place.
- Do not use excessive force when inserting the battery pack. If the battery pack does not slide in easily, it is not being inserted correctly. It is also possible that there could be damage to the battery, battery terminals or drill.

To Remove the Battery Pack

- Depress both the release buttons on the battery and slide the drill off the battery.

CHARGING YOUR BATTERIES

This tool has been shipped in a low charge condition. You should charge it prior to use.

- Plug the charger into a 240V power outlet. Connect the charger jack to the charger cradle socket.
- With the battery sitting flat on a bench/table, slide the charging cradle into the recess of the battery terminals ensuring a firm connection. Upon proper contact, the red light will illuminate.
- The batteries will take 3-5 hours to charge. This may vary up to 9 hours due to the level of charge left in the batteries and also the ambient temperature.

Caution: Charger does not automatically turn off when the battery is fully charged. Please take care not to leave the tool on the charger for excessive periods of time. Switch off the charger at mains when charging is complete.

NOTE: If light on the charger cradle fails to come on.

- Check the adaptor is securely plugged into the wall outlet and is switched on.
- Check battery is firmly seated onto the charger cradle.
- Check that the charger jack is securely connected into the charger cradle socket.

Initial Charge

- Charge your battery for 8-12 hours then use it until it runs down and only slowly operates the tool.
- Connect your battery pack to the charger and recharge for 8-12 hours again.
- Once again run your tool until only a small amount of charge remains.
- Repeat the above cycle about 4 or 5 times. This should set the battery "memory", then charge for 3-5 hours.

Important Charging Notes

- The charger and battery pack may become warm to touch while charging. This is a normal condition, and does not indicate a problem.
- Use the charger at normal room temperatures whenever possible. To prevent overheating, do not cover the charger and do not charge the battery pack in direct sunlight or near heat sources.
- If the battery pack does not charge properly:-
 1. Check current at power outlet by plugging in a lamp or other appliance.
 2. If charging problems persist, have the complete tool checked by an electrician or a power tool repairer.

Battery

The length of service from each charging cycle will depend on the type of work you are doing. The batteries in this tool have been designed to provide maximum trouble free life. However, like all batteries, they will eventually wear out.

To obtain the longest possible battery life, we suggest the following:

- Store and charge your batteries in a cool area. Temperatures above or below normal room temperature will shorten battery life.
- Never store batteries in a discharged condition. Recharge them immediately after they are discharged.

CHARGING YOUR BATTERIES (cont.)

- All batteries gradually lose their charge. The higher the temperature the quicker they lose their charge. If you store your tool for long periods of time without using it, recharge the batteries every month or two. This practice will prolong battery life.

TOOL OPERATION

The ON/OFF Switch

Turn the drill ON by depressing the switch. To turn the tool OFF, release the switch.

Speed Control

The tool has a 2-speed gearbox. 1st gear has a range 0-350 rpm. 2nd gear has a range of 0-1100 rpm. The speed can be varied from 0 to maximum in either gear, depending on the pressure applied to the switch. This way you can select the best possible speed for the job being done.

Level Indicator

Use the level indicator for accurate drilling.

Hammer Drilling

Select hammer function on the hammer/drill selector collar for drilling into masonry, brick or concrete.

Changing the Direction of Rotation

The direction of rotation can be changed with the forward/reverse selector above the switch.

To select the forward drilling position, push the selector hard left. To select the reverse drilling position, push the selector hard right.

The switch can be locked off by pushing the forward / reverse selector into the middle of both forward and reverse positions.

Do not change the direction of rotation while the chuck is still in motion.

Torque Settings

(Tightening Power of Your Cordless Drill)

When using your drill for various driving applications, it becomes necessary to increase and decrease the power and torque in order to prevent the possibility of damaging screw heads, threads, work piece, etc.

In general, power and torque should correspond to the difficulty of the screw to be driven. If torque is too high the screws may be damaged or broken.

To Adjust Torque

- Locate the arrow on the front of the housing.
- Identify the torque settings and 1 drill setting on the torque adjustment collar.
- Rotate the adjustment collar to the desired setting, aligning the number on the adjustment collar with the arrow on the housing.
- To increase or decrease torque, rotate torque adjustment collar. The lower the number, the lower the torque setting. The higher the number, the higher the torque setting.

Always check that the correct torque is selected by practising on scrap material prior to carrying out a job.

TOOL OPERATION (cont.)

Keyless Chuck

A keyless chuck has been provided with your drill to allow for easy installation and removal of bits. The chuck is divided into two parts, the rear is called the collar and the front is the body. To open and close the chuck; grasp and hold the collar of the chuck with one hand and rotate the chuck body with your other hand. The arrows on the chuck indicate which direction to rotate the chuck body in order to GRIP (tighten) or RELEASE (unlock) the drill bit.

WARNING: Do not hold the chuck body with one hand and use power of the drill to tighten or loosen the chuck jaws. The chuck body could slip and your hand could come in contact with a rotating accessory. This could cause an accident resulting in personal injury.

Installing Drill/Driver Bits

- Remove battery from the drill.
- Open or close the chuck to a point where the opening is slightly larger than the drill bit you intend to use.
- Insert the drill bit into the chuck ensuring the end of the drill bit does not touch the screw inside the chuck.
- Tighten the chuck onto the drill bit as described above (Keyless Chuck).

Removing Drill/Driver Bits

- Remove the battery from the drill.
- Loosen the chuck as described above (Keyless Chuck).
- Remove the drill bit from the chuck.

Note: Do not handle drill bits without gloves as drill bits and other accessories are sharp and can cause a personal injury.

General Hints for Drilling in all Materials

- Always use sharp drill bits.
- Mark the place where you would like the hole to be drilled.
- Commence with a slow rotation speed to start the hole.
- Reduce your pressure on the tool when the drill bit is about to break through the material.

Metal Drilling

- Support thin material with a wooden plate.
- Use a punch to mark the position of the hole.
- If drilling a large hole use a small drill at first to establish a pilot hole then use the required large size drill bit.
- Use only HSS (high speed steel) drill bits or those recommended for metal use.
- When drilling into iron or steel, use a cooling lubricant such as thin oil. With aluminium, use turpentine or paraffin. With brass, copper and cast iron, use no lubricant but withdraw the drill regularly to assist cooling.

TOOL OPERATION (cont.)

Wood Drilling

- Mark the place where you want to drill with a punch or nail.
- To avoid splintering on breakthrough either clamp a piece of scrap wood to the back of the wood or continue the hole from the back of the wood when the drill bit first breaks through.

Masonry Drilling

- Mark the place where you want to drill.
- Only use carbide tipped drill bits.
- Use the drill only in the forward position.
- Hold the drill firmly and place the bit at the point to be drilled.
- Do not force the drill. Allow the drill and the bit to do the work.
- If the bit jams in the work piece or stalls, stop the tool immediately. Remove the bit from the work piece and determine the reason for jamming.

MAINTENANCE AND CARE

- When not in use, the drill should be stored in a dry, frost free location not within the reach of children.
- Keep ventilation slots of the drill clean at all times and prevent any foreign matter from entering.
- If the housing of the drill requires cleaning, do not use solvents but a moist soft cloth only.
- Blow out the ventilation slots with compressed air periodically .

Note: Ozito Industries will not be responsible for any damage or injuries caused by repair of the sander by an unauthorised person or by mishandling of the tool.

CONTENTS

1 X OZCD18V2A Cordless Hammer Drill
2 X 18V Battery
1 x 240V Charging Adaptor & Cradle

2 x Double-ended Screwdriver Bit
1 X Instruction Manual

OZITO INDUSTRIES PTY LTD

AUSTRALIA (Head Office)

1-23 Letcon Drive, Bangholme, Victoria, Australia 3175

Telephone: 1800 069 486

Website: www.ozito.com.au

Email: enquiries@ozito.com.au

WARRANTY

THIS WARRANTY FORM AND CONFIRMED BUNNINGS REGISTER RECEIPT SHOULD BE **RETAINED BY THE CUSTOMER** AT ALL TIMES

The warranty is only made available by returning the product to your nearest Bunnings Warehouse with a **confirmed Bunnings register receipt**.

**YOUR WARRANTY FORM SHOULD BE RETAINED
BY YOU AT ALL TIMES.**

**SHOULD YOU HAVE ANY QUESTIONS PRIOR TO
RETURNING YOUR PRODUCT FOR WARRANTY OR
REPAIR PLEASE TELEPHONE OUR CUSTOMER
SERVICE HELPLINE:**

**Australia 1800 069 486
New Zealand 0508 069 486**

TO ENSURE A SPEEDY RESPONSE PLEASE HAVE THE MODEL NUMBER AND DATE OF PURCHASE AVAILABLE. AN OZITO CUSTOMER SERVICE REPRESENTATIVE WILL TAKE YOUR CALL AND ANSWER ANY QUESTIONS YOU MAY HAVE RELATING TO THE WARRANTY POLICY OR PROCEDURE.

PURCHASED FROM: _____

DATE PURCHASED: _____

3 YEAR REPLACEMENT WARRANTY

Your Ozito tool is guaranteed for a period of **36 months from the original date of purchase** and is intended for DIY (Do it yourself) use only.

WARNING

The following actions will result in the warranty being void.

- Professional, Industrial or high frequency use.
- If the tool has been operated on a supply voltage other than that specified on the tool.
- If the tool shows signs of damage or defects caused by or resulting from abuse, accidents or alterations.
- If the tool is disassembled or tampered with in any way.

Note: Warranty excludes consumable parts such as brushes, batteries, sanding pads, blades, discs, drill bits, collets and router bits.